

From: M [REDACTED]
Subject: Fwd: Figueroa Street Construction Updates
Date: April 27, 2017 at 2:47 PM
To: [REDACTED] aron@urbanplaceconsulting.com



This is the same info I sent earlier, just a cleaner version if you wanted to share with your stakeholders.

Begin forwarded message:

From: USC Transportation <usc.transportation@usc.edu>
Subject: Figueroa Street Construction Updates
Date: April 27, 2017 at 10:26:56 AM PDT
To: "'all-staff-l@usc.edu'" <all-staff-l@usc.edu>, "'all-faculty-l@usc.edu'" <all-faculty-l@usc.edu>, "'oncampus-students-l@usc.edu'" <oncampus-students-l@usc.edu>
Reply-To: USC Transportation <usc.transportation@usc.edu>

The Los Angeles Department of Transportation (LADOT) and the USC Capital Construction Development (CCD) team are both working on infrastructure improvement projects on Figueroa Street in the coming weeks. This email is to provide the current information we have regarding related traffic lane and pedestrian crosswalk closures.

USC CCD

The CCD project is related to electrical underground work, and will take place immediately after Commencement, **starting Monday, May 15th**. The location of the work (phase 1A on the attached) is on the northwest corner of the Figueroa St./Exposition Blvd. intersection, and is expected to last approximately five weeks, until June 16th. The two most important impacts are that the southbound turning lane from Figueroa onto Exposition will be closed (the actual site of the work), and the east-west crosswalk on the north side of the intersection will also be closed. The south crosswalk will remain open as an alternate, and pedestrians can also continue north on Figueroa to the crosswalk at McCarthy Way as an alternate (the dashed blue lines on the attachment).

MyFig project (LADOT)

This past weekend, LADOT placed k-rails and temporary striping on Figueroa Street between Exposition Blvd. and Adams Blvd., in preparation for the next phase of the MyFig project (full project details of which can be found [here](#)). These measures will be in place for at least the next ten weeks. The main impact is the shifting of northbound traffic lanes to the west (into the space where median islands used to be), and narrowing both northbound and southbound traffic lanes to only two lanes in each direction. We expect this will cause significant delays for the next 2½ months, and encourage all Figueroa Street users to find alternate routes whenever possible. Flower Street is a much better option southbound from downtown to the USC area, and both Vermont and Hoover Streets are better northbound options from campus. Due to the volume of guests visiting campus on Commencement Day, LADOT has agreed to limit activity in the USC area that day.

We will keep the campus community informed as more information regarding these projects becomes available. Please let us know if you have any questions.

USC Transportation
auxtrans@usc.edu
620 West McCarthy Way
Los Angeles, CA 90089





Phase 1A -
 Work on traffic lane next
 to curb
Start: 5-15-17
Finish: 6-16-17
Duration: 5 weeks

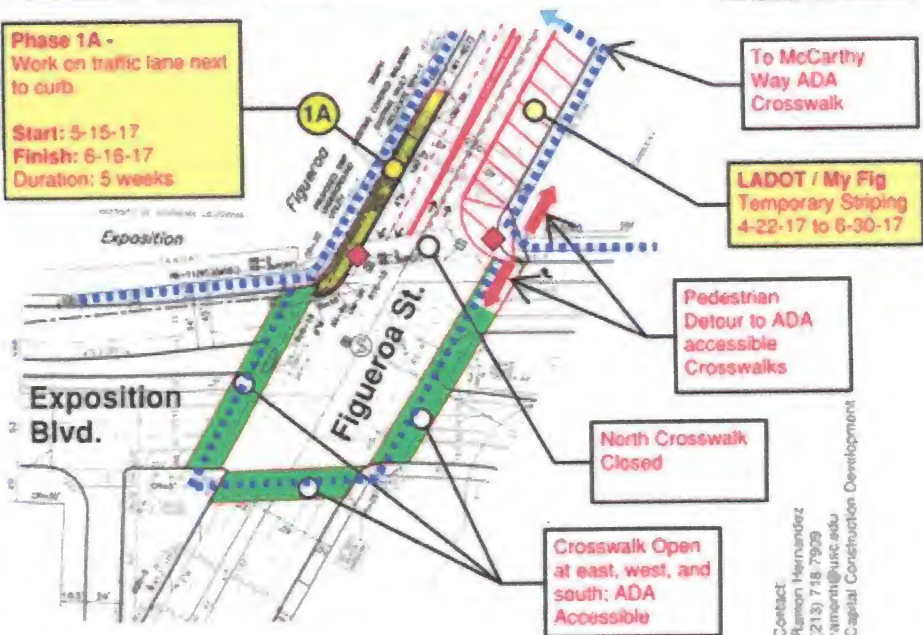

Project:
Undergrounding of Electrical Utilities
Phase 1A - Figueroa at Exposition Blvd.



Contact:
 Ramon Hernandez
 (213) 718-7929
 ramonrh@usc.edu
 Capital Construction Development

Project Specialist
 USC Local Government Relations